



For Pete's Sake Cancer Respite Foundation has been re-certified under the Pennsylvania Nonprofits Standards for Excellence program with the Seal of Excellence.

We proudly display this logo to demonstrate our continued commitment to upholding the highest standards of ethics and accountability in the nonprofit sector.

Please Note: The official registration and financial information of For Pete's Sake Respite Foundation may be obtained from the Pennsylvania Department of State by calling toll free within Pennsylvania, 1-800-732-0999. Registration does not imply endorsement. For Pete's Sake Respite Foundation assures that its solicitations are free from undue influence or excessive pressure and are respectful of the needs and interests of donors and potential donors. All gifts are utilized with the intent of the donor. To view additional state registrations, please visit our website at [www.takeabreakfromcancer.org](http://www.takeabreakfromcancer.org)



# FOR PETE'S SAKE AT A GLANCE

## THE FPS TRAVEL RESPITE PROGRAM TODAY

### RESPITE RECIPIENT DEMOGRAPHICS

**68%** of patients have advanced-stage cancer

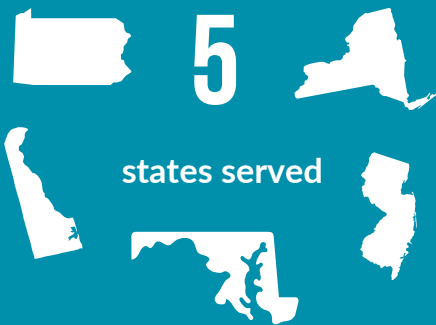

**48** meals served on Travel Respite per family

**84%** of families served are in financial duress

**205** children experienced respite in 2025

### OUR MISSION

For Pete's Sake Cancer Respite Foundation enables adult cancer patients and their loved ones to strengthen, deepen and unify their relationships by creating unforgettable and lasting Respite Experiences.

Collaborating with leading cancer centers, we offer cost-free retreats at Woodloch Resort for patients aged 21 to 55, their caregivers, and children.

FPS also offers support for patients who are too ill to travel through our **Staycation Respite** option. Additionally, we address their ongoing needs with our **Respite Reinforced Program**, which provides personalized assistance following the respite period.

### IN ACTION



Kathlene, age 36, is a single mother facing breast cancer. Despite financial challenges and restarting treatment due to medical complications, she's remained resilient and positive. But even the strongest families need time to pause and heal. Knowing this, her nominator at Doylestown Hospital saw the deep need for a break—an opportunity for Kathlene and her children to reconnect and recharge.

*"For me and my kids, it was a moment to reconnect and have fun which is something we hadn't done together in a long time. Feeling the sun on my face after spending most of the past year indoors was priceless. Even my oldest found healing by letting go of stress, praying together and walking by the lake.*

*This experience was a turning point, a joyful reminder that life after cancer is meant to be lived fully. I'm stronger now, and I'm beyond grateful to this organization and its supporters for giving my family that gift."*

# FOR PETE'S SAKE AT A GLANCE

## THE FPS TRAVEL RESPITE PROGRAM TOMORROW



# RESPITE *Transformed*

PETE'S VISION REALIZED AT WOODLOCH

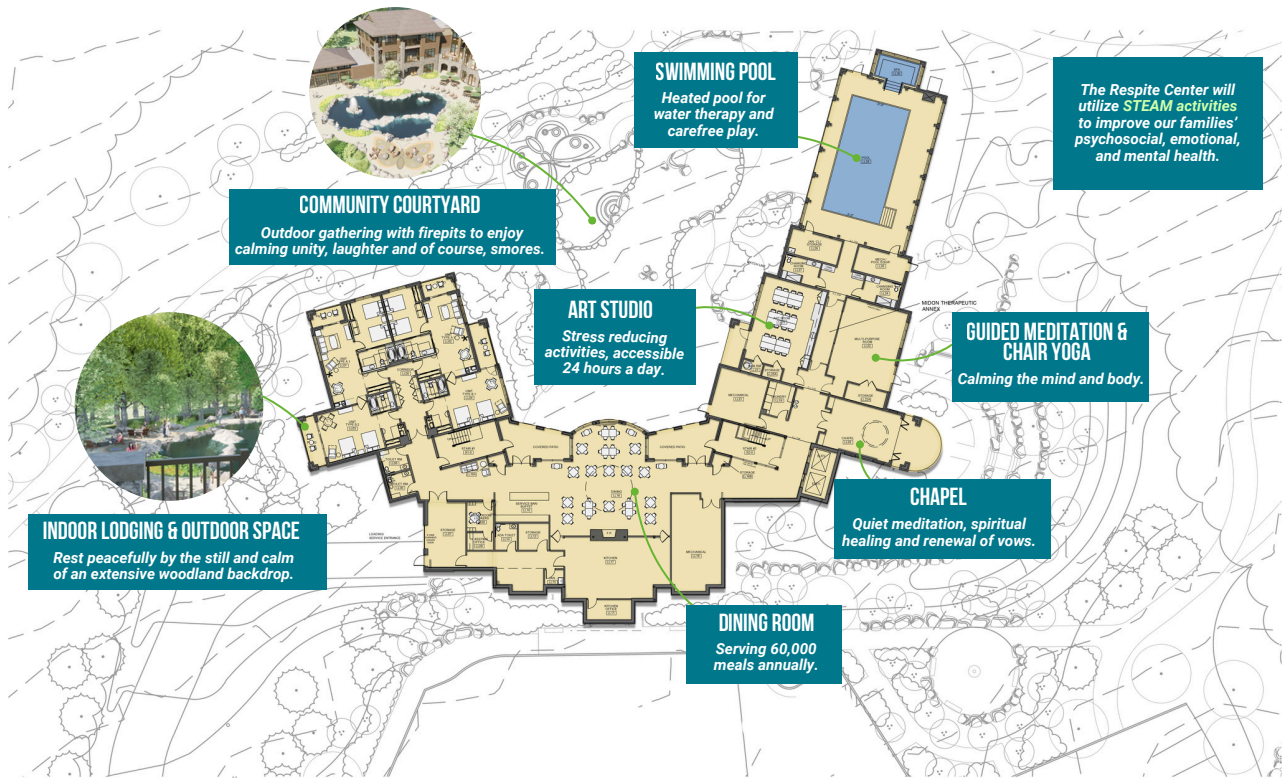

Proposed Lower Level Plan  
05.16.2023



## Helping More than Ever Before

	CURRENT		FUTURE
States Served	5	→	15
Families Served Monthly	10	→	64
Individuals Served by Respite	764	→	4,496
Nominating Cancer Centers	260	→	411
Post-Respite Support & Outreach	17,778	→	69,688
Volunteer Engagement	770	→	3,840

**FPS will scale efficiently and effectively, bringing 500,000 respite hours to 4,500 people annually.**



# EVENT SUPPORT



## FOR PETE'S SAKE GALA FEBRUARY 7, 2026

A formal evening complete with a gourmet seated dinner for over 400 guests, fine beverages, an exciting auction and a beloved Woodloch favorite—a horseracing experience reminiscent of those enjoyed by our Respite Recipients. The night ends out on the dance floor with a live band!



## NEW YORK HAPPY HOUR APRIL 22, 2026

An informal, fun evening gathering at a New York club, complete with guest bartenders, a short program, networking and mingling.



## FOR PETE'S SAKE, WALK! APRIL 26, 2026

This event is where fun meets philanthropy. Whether young or young at heart, sprinters or strollers, all ages and abilities are welcome. Participants complete three laps around the concourse at Citizens Bank Park, walk the bases, meet the beloved Philly Phanatic, enjoy delicious treats and snap photos in the dugout.



## PETER R. BOSSOW, JR. MEMORIAL GOLF TOURNAMENT FALL 2026

A favored tradition of our community, our tournament kicks off with 18 holes of golf, cocktail hour and dinner, capped off by an exciting helicopter golf ball drop and an inspiring evening program featuring a family who has benefited from an FPS Respite Experience.



# EMPLOYEE ENGAGEMENT

**Employee engagement strengthens camaraderie, boosts productivity, and instills pride in your workforce. By encouraging your team to support FPS's mission, you can:**

- ✓ Align with your corporate values and priorities
- ✓ Foster better communication and collaboration
- ✓ Alleviate stress and enhance overall productivity
- ✓ Inspire a culture of philanthropy within your organization



## CORNHOLE FOR CANCER

Bring up to 256 of your colleagues together for a few hours with a Cornhole tournament that everyone can enjoy! We set up and supply everything you need – from boards to scoring– and you get to decide how your colleagues interact and play against one another. Check out [www.cornholeforcancer.org](http://www.cornholeforcancer.org) for more detailed information.



## DAY OF SERVICE

Bring FPS to your workplace or bring your workplace to FPS! You and your team can create items that enhance the FPS Respite Experience and personalize support for FPS Families. Build care packages with thoughtful messages for respite recipients, or choose from a range of event volunteer opportunities on weekdays or weekends. We'll customize your day of service to fit your group's needs, making it an excellent option for remote teams and providing valuable support for the FPS mission.



# EMPLOYEE ENGAGEMENT



## YOUNG PROFESSIONALS SOCIETY

Looking for a way to support your young professionals? Encourage them to join the For Pete's Sake Young Professionals Society, where they can connect with fellow cancer advocates and emerging leaders aged 21 to 35 through engaging in social, networking, and fundraising events. Members will enjoy exclusive invitations and discounts to exciting activities such as Phillies games, our signature events, tailgates, and happy hours. Additionally, they'll benefit from valuable professional networking opportunities and business development activities.



## MONTHLY GIVING

Foster a culture of philanthropy within your team by encouraging employees to make monthly contributions to support our program. Donations can be conveniently deducted directly from their paychecks, credit card, or checking account. Many employers opt to set a company-wide donation goal and match their employees' contributions. For Pete's Sake handles all the setup, providing a secure giving page to ensure a smooth and efficient donation process.



## #GIVINGTUESDAY

On the Tuesday after Thanksgiving, people around the globe—from charities and families to businesses, community centers, and students—come together to celebrate generosity. Choose For Pete's Sake as your Charity of Choice and be part of this worldwide giving movement. Partnering with us provides you with a personalized webpage to collect and track contributions, and celebrate your impact. We also offer sample email and social media content, plus comprehensive support to make the process seamless, efficient, and enjoyable for everyone involved.



# CORPORATE PARTNER SPOTLIGHT



## PHILLIPS CORPORATION IS A CORPORATE PARTNER CHAMPION!

"Phillips Corporation works with For Pete's Sake because our company doesn't just want to make contributions, we want to make a difference. We appreciate the variety of ways to support families facing cancer; our company encourages our team to give monthly and we match their gifts. Additionally, we participate in #GivingTuesday, the Holiday Program and For Pete's Sake Walk!

The most beautiful thing that has resulted from our partnership is that some of our own team members have been nominated and benefited from FPS Respite over the years!"

Alan Phillips, President  
*Phillips Corporation*



In February 2024, before a day of off-site meetings, the entire Phillips Corp leadership team supported FPS by making online donations and engaging in peer fundraising at the First Annual Polar Plunge. The event raised \$10K for FPS Families while allowing the team to enjoy friendly competition, cheer each other on, and strengthen their connections.

In October 2024, Phillips' Senior Administrator Gina Owens experienced the power of respite firsthand as a facilitator during an FPS Respite.



**What's next for Phillips Corporation?** Their employees are now so deeply connected to our mission and will soon start volunteering their personal time to become trained facilitators for the travel respite program.

# Gala

## The Event - February 7, 2026

Join us for our 25th Annual For Pete's Sake Gala, a special evening dedicated to uniting our FPS Community and envisioning a future where every family battling cancer finds comfort and hope through the power of respite.

Hosted at Vie by Cescaphe, this unforgettable evening will include a gourmet seated dinner for over 400 guests, fine beverages, an exciting auction and a beloved Woodloch favorite—a horseracing experience reminiscent of those enjoyed by our Respite Recipients. Throughout the evening, our program will highlight the profound impact of respite on families facing cancer. With your generous support, we aim to provide respite for 35 families traveling this spring.

We are proud to present the Leader in Philanthropy Award to a community partner who has demonstrated remarkable dedication and leadership in advancing our mission. Additionally, we will honor oncology health professionals with our Gratitude Award, recognizing their compassionate care and significant impact on FPS Families.

The night will end on the dance floor with the sounds of our live band, as we celebrate the strength and unity of our community.



## 2025 Gala Stats

- **Where:** Vie by Cescaphe, Philadelphia
- **Attendees:** 400
- **Raised:** \$296,000

## The Reach

Social Media reach to over 10,000 followers on LinkedIn, Facebook and Instagram.

FPS featured in People, Women's Day, AARP, WMMR Radio Segment.

Name recognition with donors, patients, caregivers and healthcare professionals.

Marketing exposure to email reach of over 35,000 people.



# Sponsorship Opportunities

## Sponsorship Benefits

	Diamond \$50,000	Anniversary \$25,000	Platinum \$15,000	Gold \$10,000	Silver \$7,500	Bronze \$5,000	Friend \$2,500
<b>Tax Deductibility</b>	\$45,700	\$21,680	\$12,660	\$8,440	\$6,330	\$4,220	\$2,110
<b>Special feature on menus</b>	✓						
<b>Logo on invite*</b> <i>*Must be pledged by 11/1/25</i>	✓	✓					
<b>Meal and tour of Woodloch Resort</b>	✓	✓					
<b>Opportunity to distribute cobranded materials at the event</b>	✓	✓	✓				
<b>Verbal recognition during program</b>	✓	✓	✓	✓			
<b>Digital program ad size</b>	(2) Full	(1) Full	(1) Full	(1) Full	(1) Half	(1) Half	(1) Quarter
<b>Visibility on event website and day-of event signage</b>	Logo	Logo	Logo	Logo	Listing	Listing	Listing
<b>Guests</b>	20	16	12	8	6	4	2

## Ads à la Carte

	Size	Amount	Tax Deductibility
<b>Full page ad in digital program</b>	10" x 5.6"	\$750	100%
<b>Half page ad in digital program</b>	5" x 5.6"	\$500	100%
<b>Quarter page ad in digital program</b>	5" x 2.8"	\$250	100%

**All sponsor levels include a digital program and/or logo placement.**

- Please provide digital ads in color as JPG or PNG files, following the size specifications listed above.
- Your company logo will be featured in promotional materials and on the event website. Please provide high-quality color logos in JPG or PNG format.
- Please provide all logos and ads to [matt@takeabreakfromcancer.org](mailto:matt@takeabreakfromcancer.org) by January 19th.

# FOR PETE'S SAKE WALK!

STRIDE FOR RESPITE

## THE EVENT - APRIL 26, 2026

Get ready to Stride for Respite at the For Pete's Sake Walk! This event is where fun meets philanthropy, making a meaningful impact on families facing cancer. In 2025, over 2,100 participants joined us from near and far, breaking records in attendance and funds raised for respite!



We invite you to be part of the fun at our 2026 For Pete's Sake Walk! Whether young or young at heart, sprinters or strollers, all ages and abilities are welcome. Participants complete three laps around the concourse, walk the bases, meet the beloved Philly Phanatic, enjoy delicious treats and snap fun photos in the dugout.

The atmosphere at Citizens Bank Park is joyous, and the excitement is contagious, as each stride taken signifies that no one faces cancer alone. Participation leaves a lasting impression on everyone present – patients, caregivers, children, oncology professionals, friends, family and our dedicated sponsors.

## 2025 PHILADELPHIA REGIONAL WALK STATS

- **Where:** Citizens Bank Park
- **Average Participants:** 2,100
- **Participants from:** PA, DE, NJ, MD
- **Teams:** 110
- **Volunteers:** 150+
- **Raised:** \$260,000

## FPS REACH

Social Media reach to over 10,000 FPS followers on LinkedIn, Facebook and Instagram.

Walk featured on NBC 10 News, Action News 11, Fox 29 and Clear Channel Billboards throughout the Greater Philadelphia region and South Jersey.

Company name recognition shared to donors, patients, caregivers and healthcare professionals.

FPS email marketing database of over 35,000 people.

FPS featured in People, Women's Day, AARP, WMMR Radio Segment.

# SPONSORSHIP OPPORTUNITIES

	Local Presenting \$50,000	Diamond \$25,000	Phanavision* \$15,000	Home Run \$10,000	Bullpen \$5,000	Major League \$2,500
<b>Tax Deductibility</b>	\$47,130	\$22,750	\$13,210	\$8,520	\$3,990	\$1,690

\*Exclusive Sponsorship Level

**VISIBILITY BENEFITS**

<b>Remarks at Opening Ceremony</b>	✓					
<b>Opportunity to distribute giveaway Item at check-in</b>	✓	✓				
<b>Placement of logo on LED video Screen</b>	✓	✓	✓			
<b>Visibility on pre-event materials, T-shirt and day-of event signage</b>	Logo	Logo	Logo	Logo	Listing	Listing
<b>Complimentary Tickets to FPS Gala or Phillies Game &amp; Tailgate</b>	Gala (4)	Gala (2)	Phillies (8)	Phillies (6)	Phillies (4)	Phillies (2)
<b>Vendor Booth Table</b>	✓	✓	✓	✓	✓	✓

**TEAM BENEFITS**

<b>Complimentary Registrations</b>	35	30	25	20	10	5
<b>FPS Family Scholarship Tickets</b>	25	20	15	10	5	
<b>Invitation to the VIP Reception</b>	✓	✓	✓	✓	✓	

**Want to share resources?** Host a Vendor Booth Table for \$500!  
 \$0 tax deductible

For Pete's Sake Cancer Respite Foundation

# 12th Annual NYC Happy Hour

## The Event - April 22, 2026

We are excited to invite you to the 12th Annual NYC Happy Hour hosted by For Pete's Sake Cancer Respite Foundation. This event brings our generous community together to celebrate the powerful impact of respite for families affected by cancer.

Set in the heart of New York City at Stout NYC - Bryant Park, this event will feature a top-shelf open bar, an array of passed appetizers, and the chance to connect with over 350 community members, including business and philanthropic leaders.

In addition to the wonderful networking and socializing opportunities, attendees will have the chance to hear firsthand accounts of the profound effects that Respite Experiences have had on families. With your support, we are able to continue expanding our reach and ensuring that families facing cancer receive the respite they deserve.

This is more than just a celebration; it's a powerful reminder of the difference we can make when we come together with a common goal. We look forward to the opportunity to grow our mission and deepen our impact in the Greater New York area, and we hope you'll join us for an evening that promises to be as meaningful as it is enjoyable.



## 2025 NYC Happy Hour Stats

- **Where:** Stout NYC - Bryant Park
- **Attendees:** 350
- **Raised:** \$133,000

## The Reach

Social Media reach to over 10,000 FPS followers on LinkedIn, Facebook and Instagram.

Company name recognition shared to donors, patients, caregivers and healthcare professionals.

FPS email marketing database of over 35,000 people.

FPS featured in People, Women's Day, AARP, WMMR Radio Segment.

**2026 Sponsorship Opportunities Coming Soon!**



## THE EVENT – FALL 2026

This year marks the 27th anniversary of the Peter R. Bossow Jr. Golf Tournament, and we're thrilled to host the event at two exceptional golf courses again!

Whether you're enjoying a day on the course with colleagues for team-building, hosting a stewardship day with clients, networking for business, or just having fun, you'll be in great company with golfers who believe in making an impact.

The day kicks off with a round of golf at your selected course, followed by a gathering at the Manor House for a cocktail hour and dinner. The evening will feature an exciting raffle and an inspiring program with a Respite Recipient who will share their experiences with the FPS Respite Program.

## 2025 GOLF STATS

- **Where:** Commonwealth National Golf Club & Old York Road Country Club
- **Number of Participants:** 180
- **Participants from:** PA and NJ
- **Volunteers:** 50+
- **Raised:** \$168,000



## FPS REACH

Social Media reach to over 10,000 FPS followers on LinkedIn, Facebook and Instagram.

Company name recognition shared to donors, patients, caregivers and healthcare professionals.

FPS email marketing database of over 35,000 people.

FPS featured in People, Women's Day, AARP, WMMR Radio Segment.

**2026 SPONSORSHIP OPPORTUNITIES COMING SOON!**